



25. IPBU(U)Z



26. IPSBU(U)Z



27. IPBT010



28. IPSC



SPECIALY FOR THE SHIPBUILDING

- IPBU(U)Z 25. Bulb profiles
- IPSBU(U)Z 26. Ship sections
- IPBT010 27. Bulb profiles with a temporary tackle eye
- IPSC 28. Positioning and pulling clamp



IPBUUZ

FOR BULB PROFILES

The IPBU(U)Z shipbuilding clamps are used for the lifting, transfer and placing of bulb profiles onto ship's hulls perpendicularly. These clamps are fitted with a locking device for both open and closed positions, which ensures complete reliability. To be used exclusively for bulb profiles (not for plates).

Available in two versions:

Model IPBUUZ: with hinged hoisting eye. For correct use of the clamp, please consult fig. 2 & 3.

Model IPBUZ: with fixed hoisting eye. For correct use of the clamp, please consult fig. 4 & 5.

fig. 3
IPBUUZ

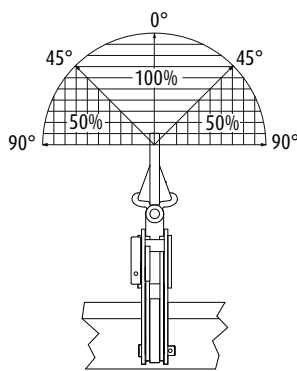

fig. 4
IPBUZ

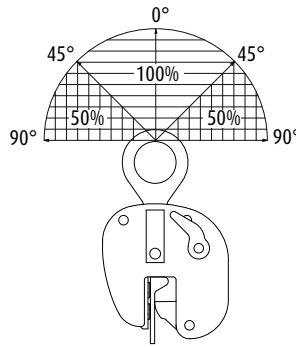

fig. 5
IPBUZ

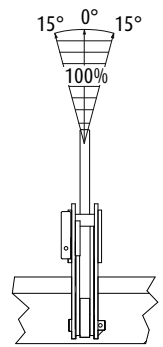

fig. 1

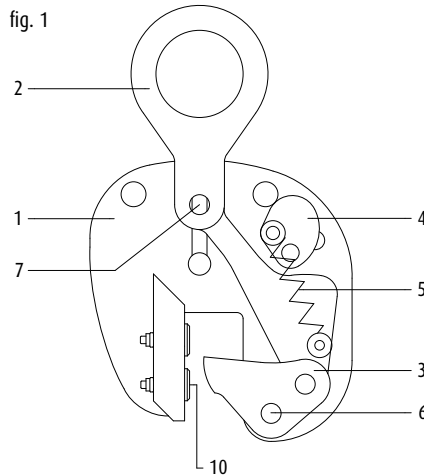
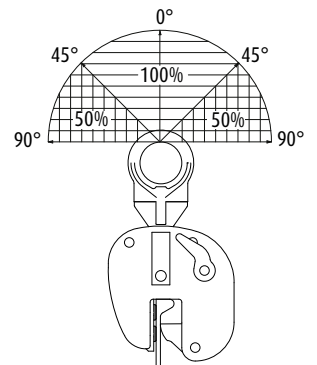

fig. 2
IPBUUZ



Spare parts for IPBU(U)Z lifting clamps: Order no.

- 1. body complete 1041
- 2. hoisting eye complete 1235
- 3. camsegment complete 1234
- 4. latch complete 1233
- 5. spring for latch complete 1063
- 6. camsegment shaft complete 1046
- 7. hoisting eye shaft complete 1047
- 10. pivot complete 0098

Dimensions in mm

Model	Stock No.	WLL Each (t.)	Weight Each (kg.)	Profile A	B	C	D	E	F	G	H	J	K
0,75 IPBUUZ	5601	0,75	8,5	HP 120-200	85	226	390	70	210	61	70	-	16
0,75 IPBUZ	5600	0,75	7,0	HP 120-200	85	226	390	70	210	61	70	-	16
1,5 IPBUZ	5701	1,5	15,0	HP 220-430	196	397	568	70	256	69	48	-	16
3,75 IPBUZ	5702	3,75	28,5	HP 220-430	238	438	565	80	355	64	100	-	20

* Design Factor based on EN 13155, and ASME B30.20.

Tlf./Phone +47 63 87 10 80 www.transportstyr.no



- Available in capacities of 0.75 thru 3.75 metric tons.
 - Jaw openings available: * for HP profiles 120 to HP 430 | HP 4.75"- 17".
 - Welded alloy steel body for strength and smaller size. Forged alloy components, where required.
 - Individually Proof Tested to 2 times the Working Load Limit with certification.
 - Company name (CrosbyIP), logo, Working Load Limit and jaw opening permanently stamped on body.
 - Each product is individually serialized, with the serial number and Proof Load test date stamped on body.
- Serial number is included on the test certificate with maintenance and warranty logbook.
- Optional IP-5000 Stinger assembly available (see page 61). Allows for easy connection between the clamp and hoist hook.
 - Maintenance replacement parts are available.
 - Manufactured by a ISO 9001 facility.
 - All sizes are RFID EQUIPPED.

fig. 6

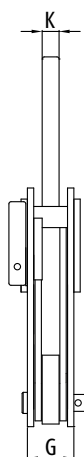

fig. 7

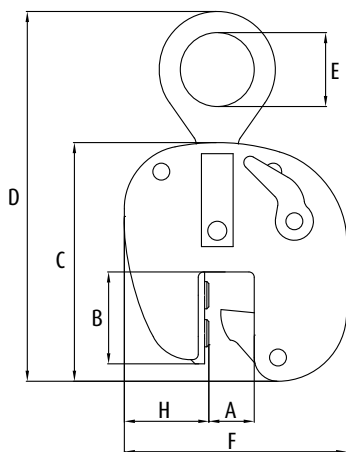
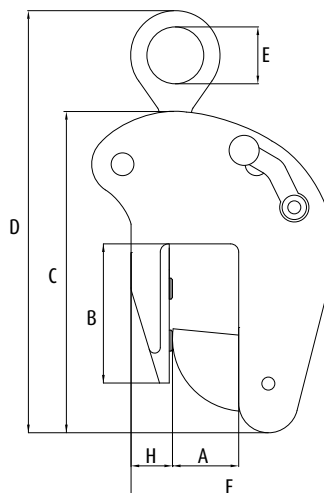

fig. 8
1,5 IPBU(U)Z



Dimensions in inches

Model	Stock No.	WLL Each (t.)	Weight Each (lbs.)	Profile A	B	C	D	E	F	G	H	J	K
0.75 IPBUUZ	2705601	0.75	18.7	HP 4.75 - 7.88	3.35	8.90	15.35	2.76	8.27	2.40	2.76	-	.63
0.75 IPBUZ	2705600	0.75	15.4	HP 4.75 - 7.88	3.35	8.90	15.35	2.76	8.27	2.40	2.76	-	.63
1.5 IPBUZ	2705701	1.5	33.1	HP 8.63 - 17.00	7.72	15.63	22.36	2.76	10.08	2.72	1.89	-	.63
3.75 IPBUZ	2705702	3.75	62.9	HP 8.63 - 17.00	9.37	17.24	22.24	3.15	13.98	2.52	3.94	-	.79

* Design Factor based on EN 13155, and ASME B30.20.

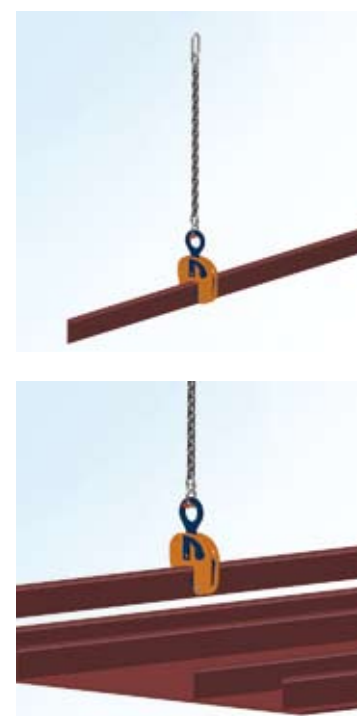



FOR SHIP SECTIONS

The IPSBU(U)Z shipbuilding clamps are used for the lifting, transfer and placing of complete ship sections. These clamps are fitted with a locking device for both open and closed positions, which ensures complete reliability. They are to be used exclusively for bulb profiles (not for plates).

Available in two versions:

Model IPSBUUZ & IPSBU(S)UZ: with hinged hoisting eye. For correct use of the clamp, please consult fig. 2 & 3.

Model IPSBUZ & IPSBU(S)Z: with fixed hoisting eye. For correct use of the clamp, see fig. 4 & 5.



IPSBUUZ

fig. 1

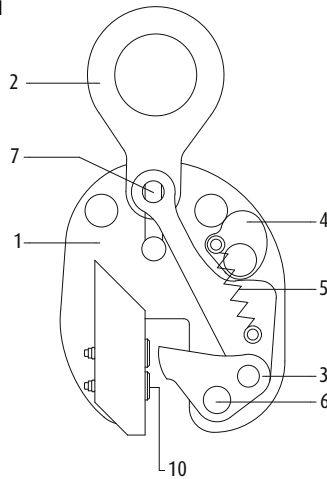

fig. 2

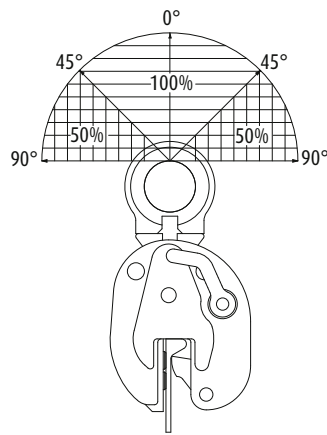
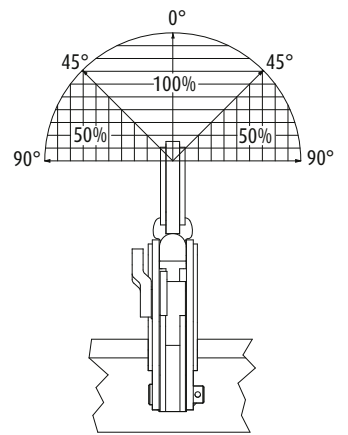

fig. 3



Spare parts for IPSBU(S)(U)Z lifting clamps: Order no.

- 1. body complete 1041
- 2. hoisting eye complete 1235
- 3. camsegment complete 1234
- 4. latch complete 1233
- 5. spring for latch complete 1063
- 6. camsegment shaft complete 1046
- 7. hoisting eye shaft complete 1047
- 10. pivot complete 0098
- 10. pivot complete (oval) 0099

Dimensions in mm

Model	Stock No.	WLL Each (t.)	Weight Each (kg.)	Profile A	B	C	D	E	F	G	H	J	K
4,5 IPSBUUZ	5771	4,5	15,5	HP 100-160	107	252	450	75	206	96	82	36	20
4,5 IPSBUSUZ	5772	4,5	38,0	HP 180-430	227	428	635	75	377	95	128	-	20
9 IPSBUUZ	5773	9,0	43,0	HP 100-160	105	274	491	80	248	123	104	44	20
9 IPSBUSUZ	5774	9,0	59,0	HP 180-430	227	478	718	80	425	118	155	44	25

4,5 IPSBUZ	5721	4,5	13,5	HP 100-160	107	252	382	75	206	96	82	-	20
4,5 IPSBUSZ	5722	4,5	35,8	HP 180-430	227	428	592	75	377	95	128	-	20
9 IPSBUZ	5723	9,0	23,0	HP 100-160	105	274	461	80	248	123	104	-	30
9 IPSBUSZ	5724	9,0	68,0	HP 180-430	227	478	672	80	425	118	155	45	25
15 IPSBUSZ	5728	15,0	64,0	HP 180-430	226	485	690	88	401	100	135	49	25
22,5 IPSBUSZ	5730	22,5	100	HP 180-430	224	543	740	90	470	116	185	-	30

* Design Factor based on EN 13155, and ASME B30.20.

Tlf./Phone +47 63 87 10 80 www.transportstyr.no



- Available in capacities of 4.5 thru 22.50 metric tons (Higher WLL and jaw openings are available upon request).
- Wide variety of jaw openings available: HP profiles 100 to HP 430 | HP 4" - 17".
- Welded alloy steel body for strength and smaller size. Forged alloy components, where required.
- Individually Proof Tested to 2 times the Working Load Limit with certification.
- Company name (CrosbyIP), logo, Working Load Limit and jaw opening permanently stamped on body.
- Each product is individually serialized, with the serial number and Proof Load test date stamped on body. Serial number is included on the test certificate with maintenance and warranty logbook.
- Optional IP-5000 Stinger assembly available (see page 61). Allows for easy connection between the clamp and hoist hook.
- Maintenance replacement parts are available.
- Manufactured by a ISO 9001 facility.
- All sizes are RFID EQUIPPED.

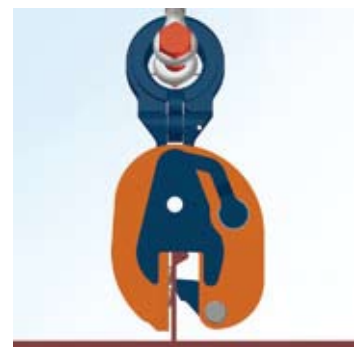
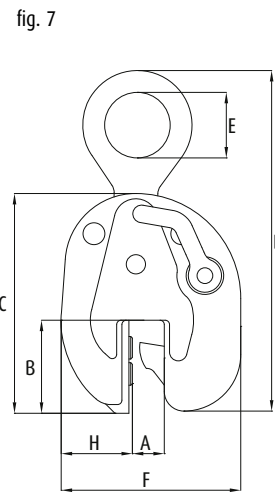
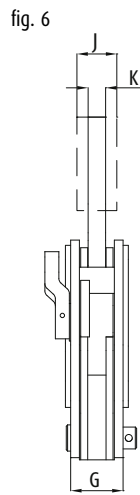
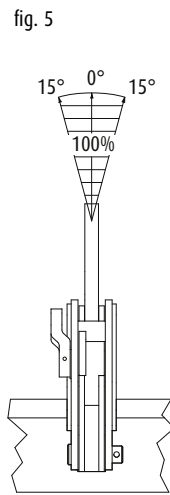
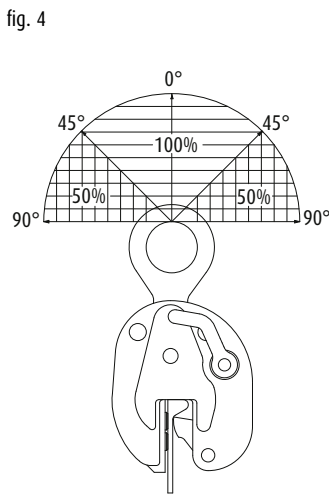

Dimensions in inches

Model	Stock No.	WLL Each (t.)	Weight Each (lbs.)	Profile A	B	C	D	E	F	G	H	J	K
4.5 IPSBUUZ	2705771	4.5	34.2	HP 4.00 - 6.25	4.21	9.92	17.72	2.95	8.11	3.78	3.23	1.42	.79
4.5 IPSBUSUZ	2705772	4.5	83.8	HP 7.13 - 17.00	8.94	16.85	25.00	2.95	14.84	3.74	5.04	-	.79
9 IPSBUUZ	2705773	9.0	94.8	HP 4.00 - 6.25	4.13	10.79	19.33	3.15	9.76	4.84	4.09	1.73	.79
9 IPSBUSUZ	2705774	9.0	130	HP 7.13 - 17.00	8.94	18.82	28.27	3.15	16.73	4.65	6.10	1.73	.98

4.5 IPSBUZ	2705721	4.5	29.8	HP 4.00 - 6.25	4.21	9.92	15.04	2.95	8.11	3.78	3.23	-	.79
4.5 IPSBUSZ	2705722	4.5	78.9	HP 7.13 - 17.00	8.94	16.85	23.31	2.95	14.84	3.74	5.04	-	.79
9 IPSBUZ	2705723	9.0	50.7	HP 4.00 - 6.25	4.13	10.79	18.15	3.15	9.76	4.84	4.09	-	1.18
9 IPSBUSZ	2705724	9.0	150	HP 7.13 - 17.00	8.94	18.82	26.46	3.15	16.73	4.65	6.10	1.77	.98
15 IPSBUSZ	2705728	15.0	141	HP 7.13 - 17.00	8.90	19.09	27.17	3.46	15.79	3.94	5.31	1.93	.98
22.5 IPSBUSZ	2705730	22.5	221	HP 7.13 - 17.00	8.82	21.38	29.13	3.54	18.50	4.57	7.28	-	1.18

* Design Factor based on EN 13155, and ASME B30.20.



IPBT010

BULB PROFILES – FOR USE AS A TEMPORARY TACKLE EYE

The IPBT010 shipbuilding clamp is used as a temporary tackle eye in spaces which have been reinforced with HP (bulb) profiles such as engine rooms and ship sections. This clamp is fitted with a screwed spindle for easy attachment of the clamp. The moment a load is applied, the clamp is automatically fixed.

For correct use of the clamp, please consult fig. 2 & 3.

fig. 1

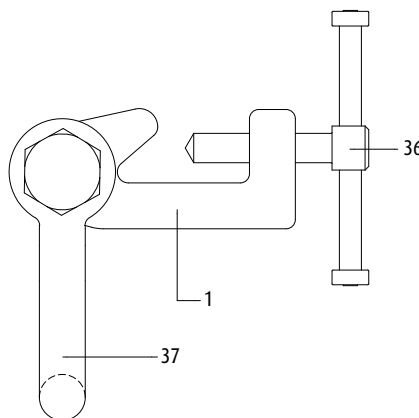
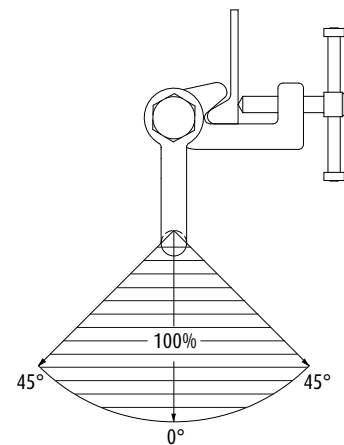

fig. 2



Spare parts for IPBT010 lifting clamps: Order no.

1. body complete	1041
36. screwed spindle complete	1254
37. shackle complete	1283

Dimensions in mm

Model	Stock No.	WLL Each (t.)	Weight Each (kg.)	Profile A	B	C	D	E	F	G	H	J	K
1,5 IPBT010	0980	1,5	4,3	HP 160-240	137	188-209	129-150	68	81	-	-	-	-
3 IPBT010	0986	3,0	6,0	HP 240-320	137	188-217	145-174	68	78	-	-	-	-
6 IPBT010	0991	6,0	13,0	HP 300-430	185	255-297	195-236	98	102	-	-	-	-

* Design Factor based on EN 13155, and ASME B30.20.

Tlf./Phone +47 63 87 10 80 www.transportstyr.no



- Available in capacities of 1.5 thru 6 metric tons (Higher WLL and different jaw openings (HP profiles) upon request).
- Wide variety of jaw openings available: HP profiles 160 to 430 | HP 6.25" - 17".
- Forged alloy components where required.
- Individually Proof Tested to 2 times the Working Load Limit with certification.
- Company name (CrosbyIP), logo, Working Load Limit and jaw opening permanently stamped on body.
- Each product is individually serialized, with the serial number and Proof Load test date stamped on body. Serial number is included on the test certificate with maintenance and warranty logbook.
- Maintenance replacement parts are available.
- Manufactured by a ISO 9001 facility.

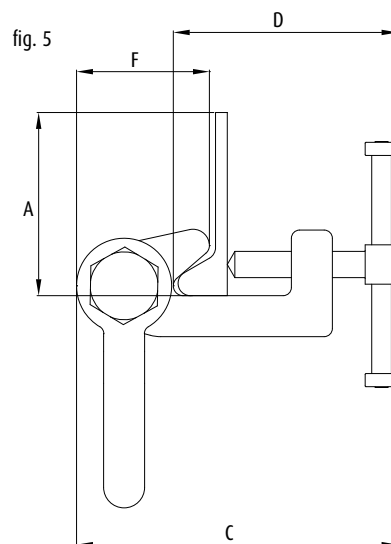
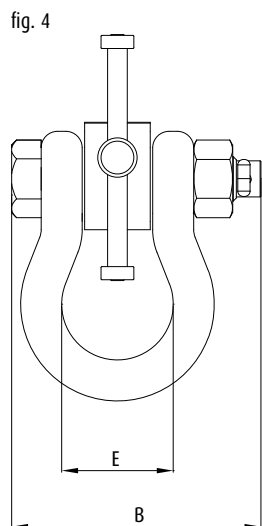
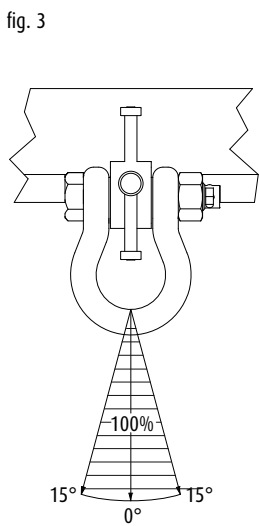

Dimensions in inches

Model	Stock No.	WLL Each (t.)	Weight Each (lbs.)	Profile A	B	C	D	E	F	G	H	J	K
1.5 IPBT010	2700980	1.5	9.48	HP 6.25 - 9.44	5.39	7.4 - 8.23	5.08 - 5.91	2.68	3.19	-	-	-	-
3 IPBT010	2700986	3.0	13.2	HP 9.44 - 12.56	5.39	7.4 - 8.54	5.71 - 6.85	2.68	3.07	-	-	-	-
6 IPBT010	2700991	6.0	28.7	HP 11.75 - 17.00	7.28	10.03 - 11.69	7.68 - 9.29	3.86	4.02	-	-	-	-

* Design Factor based on EN 13155, and ASME B30.20.



IPSC

FOR POSITIONING AND PULLING

The IPSC screw style clamp is for positioning, and pulling of plate or fabrications.

Not to be used as a lifting clamp!

For correct use of the clamp, see fig. 2 & 3.

fig. 1

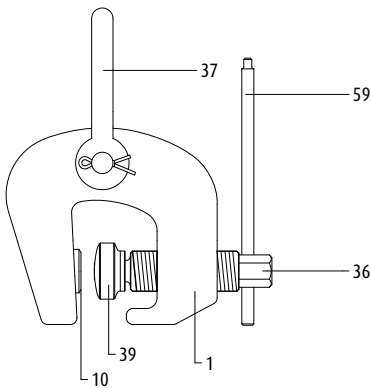

fig. 2

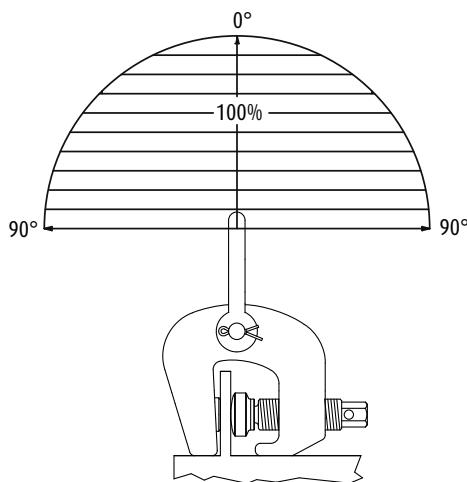
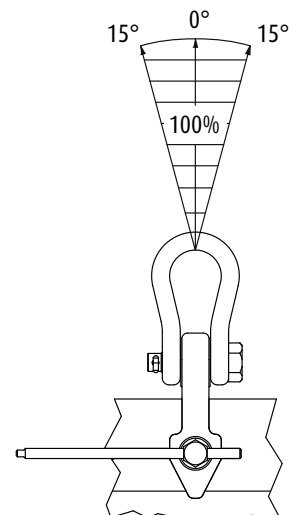

fig. 3



Spare parts for IPSC lifting clamps:

- | | |
|------------------------------|------|
| 1. body complete | 1041 |
| 10. pivot complete | 0098 |
| 36. screwed spindle complete | 1362 |
| 37. shackle complete | 1363 |
| 39. pivot 2 complete | 1371 |
| 59. grip complete | 0341 |

Dimensions in mm

Model	Stock No.	WLL Each (t.)	Weight Each (kg.)	Jaw A	B	C	D	E	F	G	H	J	K
1,5 IPSC	1640	1,5	4,0	0 - 32	91	143	229	45	154	46	52	16	52
3 IPSC	1641	3,0	6,0	0 - 50	105	165	265	50	190	54	59	19	60

* Design Factor based on EN 13155, and ASME B30.20.

Tlf./Phone +47 63 87 10 80 www.transportstyr.no



- Available in capacities of 1.5 and 3 metric tons.
- Jaw openings available: 0 to 50mm | 0" - 2").
- Suitable for steel with a surface hardness up to 30 Rc.
- Forged alloy steel body for strength and smaller size. Forged alloy components, where required.
- Individually Proof Tested to 2 times the Working Load Limit with certification.
- Company name (CrosbyIP), logo, Working Load Limit and jaw opening permanently stamped on body.
- Each product is individually serialized, with the serial number and Proof Load test date stamped on body. Serial number is included on the test certificate with maintenance and warranty logbook.
- Maintenance replacement parts are available.
- Manufactured by a ISO 9001 facility.

fig. 4

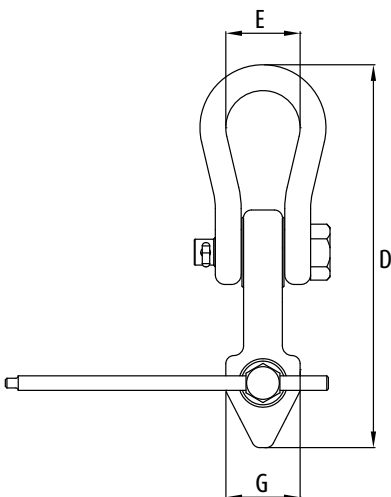
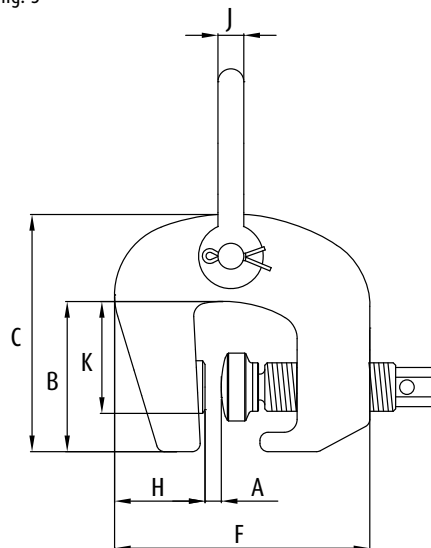

fig. 5



Dimensions in inches

Model	Stock No.	WLL Each (t.)	Weight Each (lbs.)	Jaw A	B	C	D	E	F	G	H	J	K
1.5 IPSC	2701640	1.5	8.82	0 - 1.25	3.58	5.63	9.02	1.77	6.06	1.81	2.05	.63	2.05
3 IPSC	2701641	3.0	13.2	0 - 2.00	4.13	6.50	10.43	1.97	7.48	2.13	2.32	.75	2.36

* Design Factor based on EN 13155, and ASME B30.20.

