



13. IPBC
page 36



18. IPBHZ



16. IPTK/W



19. IPBSNZ



17. IPBKZ



20. IPSTARTEC11



HORIZONTAL TRANSPORT OF BEAMS

- IPBC 13. With pretension
- IPTK/W 16. Temporary tackle-eye
- IPBKZ 17. Transfer and stacking
- IPBHZ 18. Transfer and stacking
- IPBSNZ 19. Transfer and stacking
- IPSTARTEC11 20. Controlled tilting and transport



MULTI-PURPOSE BEAM CLAMP

This IPTK series beam clamp is suitable for use as a temporary tackle eye for a beam, lifting clamp and as a lashing clamp. Load carrying capacity up to 15° from the center line of the clamp.

Optional feature: special offshore version, model IPTKO (including 3.1 B certificate).

Also available: model IPTKW without hoisting eye. All other parts and functions of the IPTKW clamp are identical to those of the IPTK beam clamp.

For correct use of the clamp, please consult fig. 2.



IPTK

fig. 1

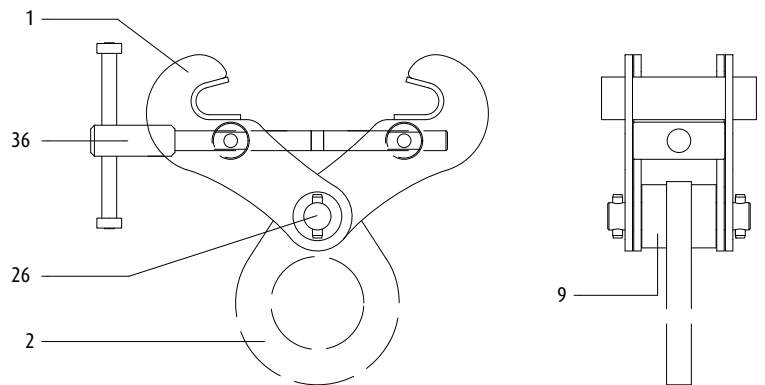

Spare parts for IPTK and IPTKW lifting clamps: Order no.

1. body complete	1041
2. hoisting eye complete (IPTK)	1235
9. distance collar (IPTKW)	1337
26. hinge shaft complete	0232
36. screwed spindle complete	1362

Dimensions in mm

Model	Stock No.	WLL Each (t.)	Weight Each (kg.)	Jaw A	B	C	D	E	F	G	H	J	K
2 IPTK	0996	2,0	6,0	75-190	-	A+ 80	125	75	-	-	22	-	20
3 IPTK	0997	3,0	6,5	75-190	-	A+ 80	125	75	-	-	22	-	20
4 IPTK	0998	4,0	8,5	150-280	-	A+100	125	75	-	-	35	-	20
5 IPTK	0994	5,0	11,0	120-350	-	A+195	125	75	-	-	40	-	20
10 IPTK	0970	10,0	31,0	300-500	-	A+300	171	74	-	-	40	-	30
25 IPTK	2999	25,0	225	450-1020	-	A+220	500	125	-	-	76	-	45

2 IPTKW	0966	2,0	4,0	75-190	-	A+ 80	125	-	28	-	22	-	-
3 IPTKW	0967	3,0	4,5	75-190	-	A+ 80	125	-	28	-	22	-	-
4 IPTKW	0968	4,0	6,3	150-280	-	A+ 100	125	-	33	-	35	-	-
5 IPTKW	0969	5,0	8,8	120-350	-	A+ 195	125	-	33	-	40	-	-

* Design Factor based on EN 13155, and ASME B30.20.

www.transportutstyr.no

Tlf./Phone +47 63 87 10 80



IPTKW



- Available in capacities of 2 thru 25 metric tons.
- Wide variety of jaw openings available: 75 to 1020mm | 3." - 40.".
- Welded alloy steel body for strength and smaller size. Forged alloy components, where required.
- Individually Proof Tested to 2 times the Working Load Limit with certification.
- Company name (CrosbyIP), logo, Working Load Limit and jaw opening permanently stamped on body.
- Each product is individually serialized, with the serial number and Proof Load test date stamped on body. Serial number is included on the test certificate with maintenance and warranty logbook.
- Maintenance replacement parts are available.
- Manufactured by a ISO 9001 facility.
- All sizes are RFID EQUIPPED.

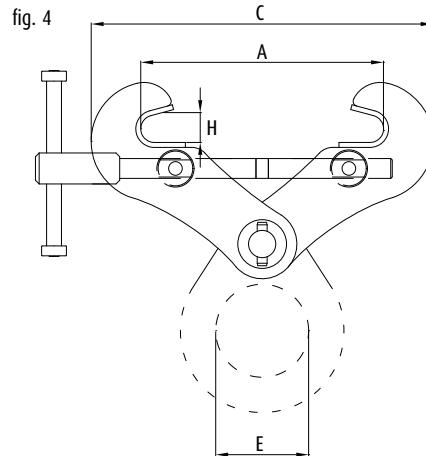
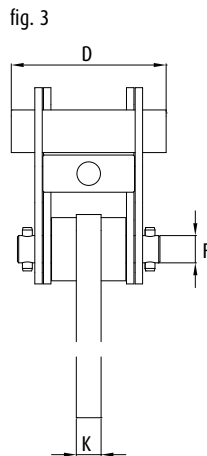
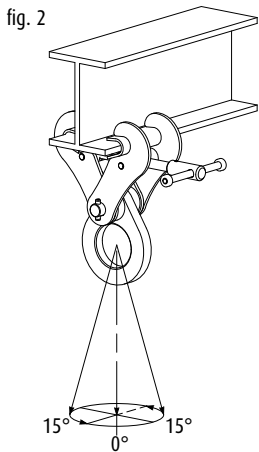

IPTKW

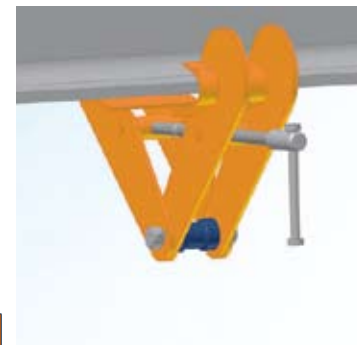

Dimensions in inches

Model	Stock No.	WLL Each (t.)	Weight Each (lbs.)	Jaw A	B	C	D	E	F	G	H	J	K
2 IPTK	2700996	2.0	13.2	3.00 - 7.50	-	A+ 3.13	4.92	2.95	-	-	.87	-	.79
3 IPTK	2700997	3.0	14.3	3.00 - 7.50	-	A+ 3.13	4.92	2.95	-	-	.87	-	.79
4 IPTK	2700998	4.0	18.7	5.88 - 11.25	-	A+ 4.00	4.92	2.95	-	-	1.38	-	.79
5 IPTK	2700994	5.0	24.3	4.75 - 13.75	-	A+ 7.67	4.92	2.95	-	-	1.57	-	.79
10 IPTK	2700970	10,0	68.3	11.75- 19.70	-	A+11.75	6.98	2.91	-	-	1.57	-	1.18
25 IPTK	2702999	25.0	496	18.00 - 40.00	-	A+ 8.66	19.69	4.92	-	-	2.99	-	1.77
2 IPTKW	2700966	2.0	8.82	3.00 - 7.50	-	A+ 3.13	4.92	-	1.10	-	.87	-	-
3 IPTKW	2700967	3.0	9.92	3.00 - 7.50	-	A+ 3.13	4.92	-	1.10	-	.87	-	-
4 IPTKW	2700968	4.0	13.9	5.88 - 11.25	-	A+ 4.00	4.92	-	1.30	-	1.38	-	-
5 IPTKW	2700969	5.0	19.4	4.75 - 13.75	-	A+ 7.67	4.92	-	1.30	-	1.57	-	-

* Design Factor based on EN 13155, and ASME B30.20.



FOR THE TRANSFER AND STACKING OF STEEL BEAMS

The IPBKZ beam clamp is used for lifting, transfer and stacking of H-Beams. An over-center hoist eye allows for the beam flange to remain vertical. This series of clamps can be used in the vertical and horizontal moving, transfer and stacking of different types of structural designs, such as I-Beams, angles, etc, depending on the application desired.

Minimal width of the flange with a jaw opening of

5 - 15mm: width 60mm

5 - 25mm: width 75mm

5 - 28mm: width 120mm

Minimum WLL of 10% of Maximum WLL.

For correct use of the clamp, please consult fig. 2 & 3.



IPBKZ

fig. 1

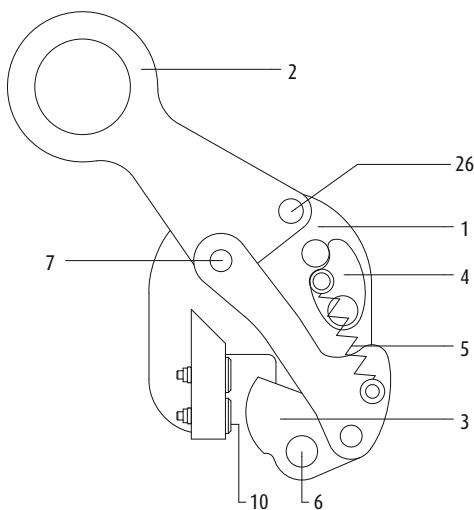

Spare parts for IPBKZ lifting clamps:

1. body complete
2. hoisting eye complete
3. camsegment complete
4. latch complete
5. spring for latch complete
6. camsegment shaft complete
7. hoisting eye shaft complete
10. pivot complete
26. hinge shaft complete

Order no.

- 1041
1235
1234
1233
1063
1046
1047
0098
0232

3, 5 and 10 are included in maintenance kit IPBKZ.

fig. 2

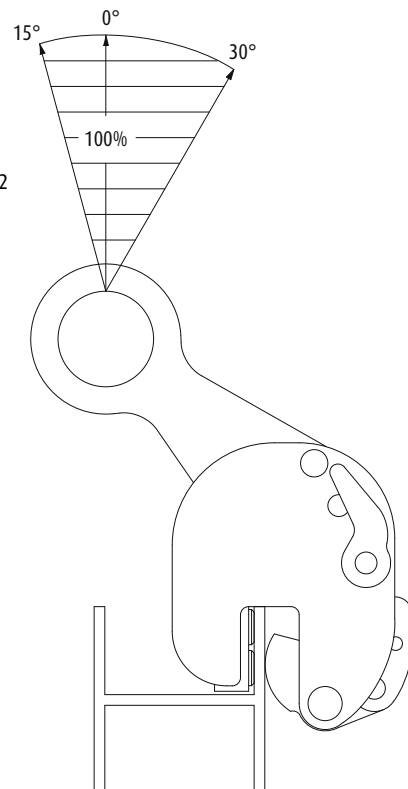

Dimensions in mm

Model	Stock No.	WLL Each (t.)	Weight Each (kg.)	Jaw A	B	C	D	E	F	G	H	J	K
0,75 IPBKZ	5780	0,75	3,5	5-15	43	132	192	45	113	47	38	10	-
1,5 IPBKZ	5781	1,5	7,0	5-25	62	210	300	70	163	61	50	16	-
3,75 IPBKZ	5782	3,75	15,5	5-28	75	260	415	100	202	78	52	20	-

* Design Factor based on EN 13155, and ASME B30.20.

www.transportutstyr.no

Tlf./Phone +47 63 87 10 80



- Available in capacities of 0.75 thru 3.75 metric tons (Higher WLL and jaw openings are available upon request).
- Wide variety of jaw openings available: 5 to 28mm | .19" - 1.13".
- Welded alloy steel body for strength and smaller size. Forged alloy components, where required.
- Individually Proof Tested to 2 times the Working Load Limit with certification.
- Company name (CrosbyIP), logo, Working Load Limit and jaw opening permanently stamped on body.
- Each product is individually serialized, with the serial number and Proof Load test date stamped on body. Serial number is included on the test certificate with maintenance and warranty logbook.
- Optional IP-5000 Stinger assembly available (see page 61). Allows for easy connection between the clamp and hoist hook.
- Maintenance replacement kits are available.
- Manufactured by a ISO 9001 facility.
- All sizes are RFID EQUIPPED.

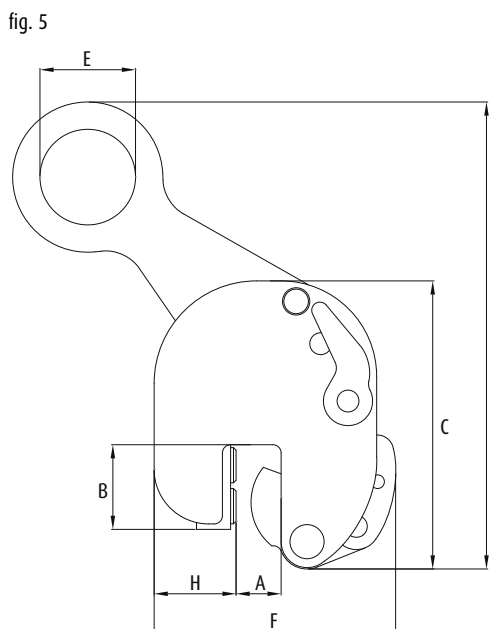
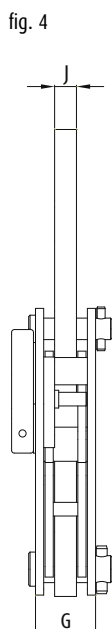
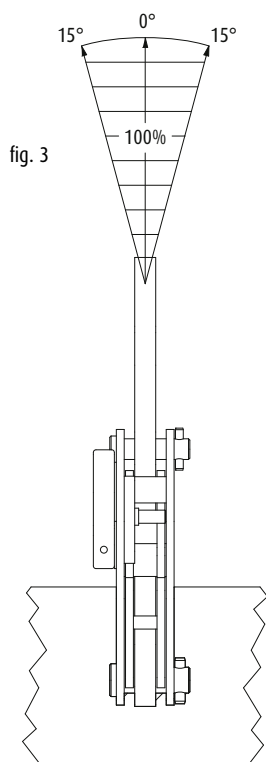

Dimensions in inches

Model	Stock No.	WLL Each (t.)	Weight Each (lbs.)	Jaw A	B	C	D	E	F	G	H	J	K
0.75 IPBKZ	2705780	0.75	7.72	.19 - .63	1.69	5.20	7.56	1.77	4.45	1.85	1.50	.39	-
1.5 IPBKZ	2705781	1.5	15.4	.19 - 1.00	2.44	8.27	11.81	2.76	6.42	2.40	1.97	.63	-
3.75 IPBKZ	2705782	3.75	34.2	.19 - 1.13	2.95	10.24	16.34	3.94	7.95	3.07	2.05	.79	-



* Design Factor based on EN 13155, and ASME B30.20.



FOR THE LIFTING AND TRANSFER OF STEEL BEAMS

The IPBHZ beam clamp is used for horizontal lifting and transfer of steel beams. The base is slotted to allow the clamps to be used from end of beams as well as from the flange. This series of clamps can be used in the vertical and horizontal moving, transfer and stacking of different types of structural designs, such as I-Beams, H-beams, angles, etc., depending on the application desired.

Also available: the special **IPBHX**, with enforced frame for handling large pipe sections.

For correct use of the clamp, please consult fig. 2 & 3.



IPBHZ

fig. 1

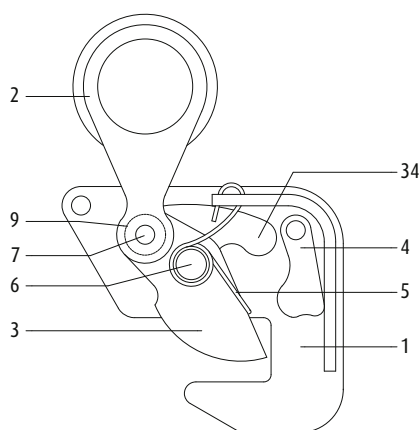

Spare parts for IPBHZ lifting clamps:

1. body complete
2. hoisting eye complete
3. camsegment complete
4. latch complete
5. spring for latch complete
6. camsegment shaft complete
7. hoisting eye shaft complete
9. distance collar complete
34. latch plate complete

Order no.

- 1041
1235
1234
1233
1063
1046
1047
1337
1353

fig. 2

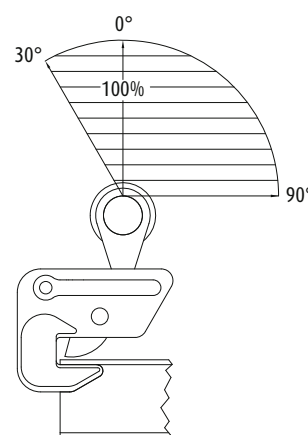
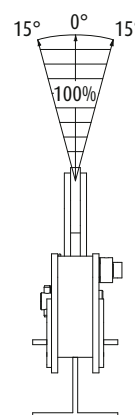

fig. 3



Dimensions in mm

Model	Stock No.	WLL Each (t.)	Weight Each (kg.)	Jaw A	B	C	D	E	F	G	H	J	K
0,75 IPBHZ	5461	0,75	3,0	0-25	40	148	220	50	130	69	-	33	22
1,5 IPBHZ	5462	1,5	6,0	0-25	60	200	255	50	153	73	-	35	28
3 IPBHZ	5463	3,0	10,5	0-40	80	227	325	70	188	112	-	38	32
4,5 IPBHZ	5464	4,5	25,0	0-40	112	284	413	70	251	116	-	80	40
12 IPBHZ	5467	12,0	42,0	0-40	125	466	490	90	317	90	-	90	47

* Design Factor based on EN 13155, and ASME B30.20.

www.transportutstyr.no

Tlf./Phone +47 63 87 10 80



- Available in capacities of 0.75 thru 4.5 metric tons (Higher WLL and jaw openings are available upon request).
- Wide variety of jaw openings available: 0 to 40mm | 0" - 1.57".
- Welded alloy steel body for strength and smaller size. Forged alloy components, where required.
- Individually Proof Tested to 2 times the Working Load Limit with certification.
- Company name (CrosbyIP), logo, Working Load Limit and jaw opening permanently stamped on body.
- Each product is individually serialized, with the serial number and Proof Load test date stamped on body. Serial number is included on the test certificate with maintenance and warranty logbook.
- Maintenance replacement parts are available.
- Manufactured by a ISO 9001 facility.
- All sizes are RFID EQUIPPED.

fig. 4

fig. 5

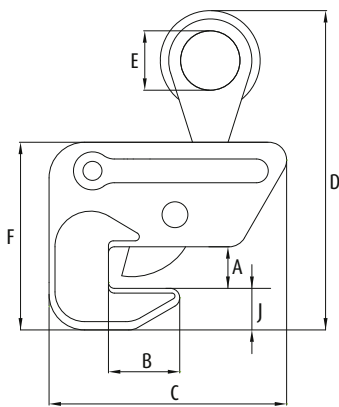
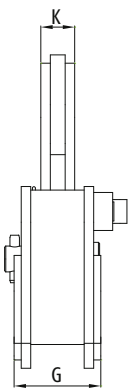

Dimensions in inches

Model	Stock No.	WLL Each (t.)	Weight Each (lbs.)	Jaw A	B	C	D	E	F	G	H	J	K
0.75 IPBHZ	2705461	0.75	6.61	0 - 1.00	1.57	5.83	8.66	1.97	5.12	2.72	-	1.30	.87
1.5 IPBHZ	2705462	1.5	13.2	0 - 1.00	2.36	7.87	10.04	1.97	6.02	2.87	-	1.38	1.10
3 IPBHZ	2705463	3.0	23.2	0 - 1.56	3.15	8.94	12.80	2.76	7.40	4.41	-	1.50	1.26
4.5 IPBHZ	2705464	4.5	55.2	0 - 1.56	4.41	11.18	16.26	2.76	9.88	4.57	-	3.15	1.57
12 IPBHZ	2705467	12.0	92.6	0 - 1.56	4.92	18.35	19.29	3.54	12.48	3.54	-	3.54	1.85

* Design Factor based on EN 13155, and ASME B30.20.

IPBHX

www.transportutstyr.no

Tlf./Phone +47 63 87 10 80



FOR THE LIFTING, TRANSFER AND STACKING OF STEEL BEAMS

The IPBSNZ beam clamp is used for lifting, transfer and stacking. Offset hoisting eye allows for level lifts of I-Beams, also for lifting fabrications and ship sections. This series of clamps can be used in the vertical and horizontal moving, transfer and stacking of different types of structural designs, such as I-Beams, depending on the application desired.

For correct use of the clamp, please consult fig. 2 & 3.



IPBSNZ

fig. 1

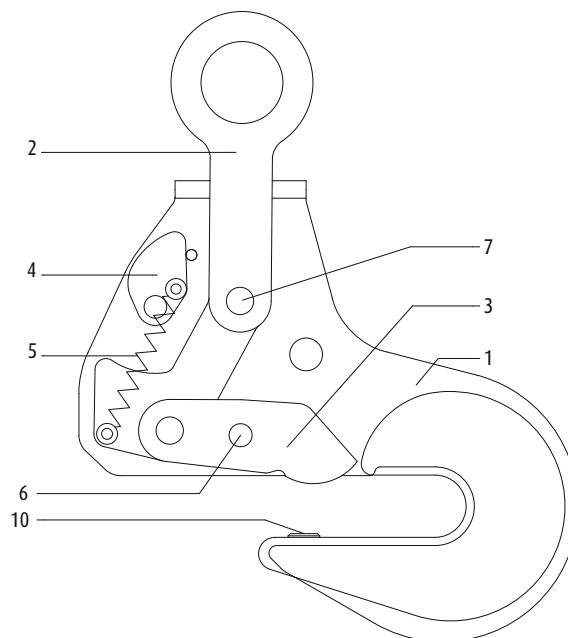

Spare parts for IPBSNZ lifting clamps:

1. body complete
2. hoisting eye complete
3. camsegment complete
4. latch complete
5. spring for latch complete
6. camsegment shaft complete
7. hoisting eye shaft complete
10. pivot complete

Order no.
1041
1235
1234
1233
1063
1046
1047
0098

fig. 2

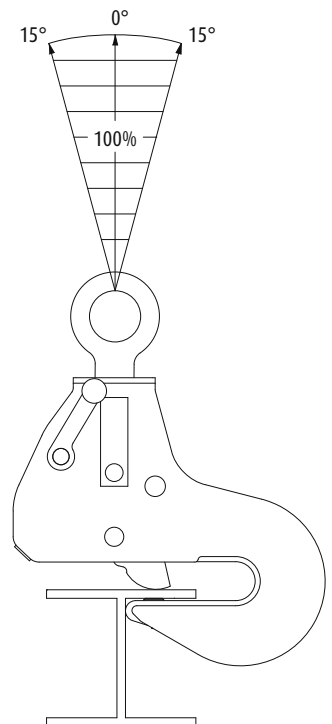

Dimensions in mm

Model	Stock No.	WLL Each (t.)	Weight Each (kg.)	Jaw A	B	C	D	E	F	G	H	J	K	L
1,5 IPBSNZ	5925	1,5	14,0	0-32	100-270	304	480	70	319	47	16	165	148	240
3,0 IPBSNZ	5926	3,0	22,0	0-40	100-330	352	494	75	408	56	20	207	182	260
4,5 IPBSNZ	5927	4,5	30,5	0-50	100-360	420	630	75	457	56	20	250	188	293

* Design Factor based on EN 13155, and ASME B30.20.

www.transportutstyr.no

Tlf./Phone +47 63 87 10 80



- Available in capacities of 1.5 thru 4.5 metric tons (Higher WLL and jaw openings are available upon request).
- Wide variety of jaw openings available: 0 to 50mm | 0" - 2".
- Welded alloy steel body for strength and smaller size. Forged alloy components, where required.
- Individually Proof Tested to 2 times the Working Load Limit with certification.
- Company name (CrosbyIP), logo, Working Load Limit and jaw opening permanently stamped on body.
- Each product is individually serialized, with the serial number and Proof Load test date stamped on body. Serial number is included on the test certificate with maintenance and warranty logbook.
- Maintenance replacement parts are available.
- Manufactured by a ISO 9001 facility.
- All sizes are RFID EQUIPPED.

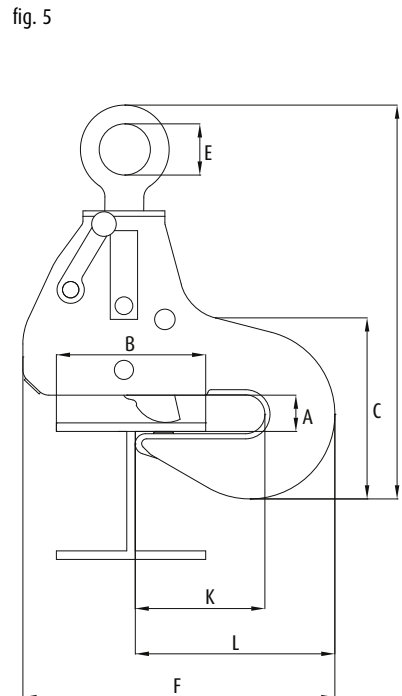
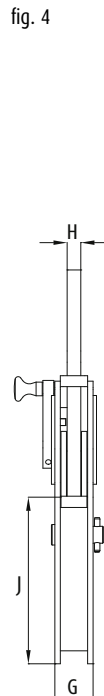
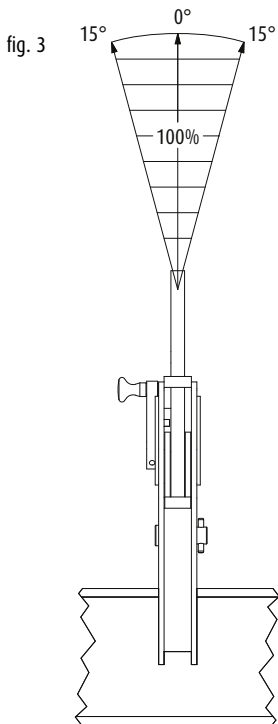

Dimensions in inches

Model	Stock No.	WLL Each (t.)	Weight Each (lbs.)	Jaw A	B	C	D	E	F	G	H	J	K	L
1.5 IPBSNZ	2705925	1.5	30.9	0 - 1.25	3.94 - 10.63	11.97	18.90	2.76	12.56	1.85	.63	6.50	5.83	9.45
3.0 IPBSNZ	2705926	3.0	48.5	0 - 1.56	3.94 - 12.99	13.86	19.45	2.95	16.06	2.20	.79	8.15	7.17	10.24
4.5 IPBSNZ	2705927	4.5	67.2	0 - 2.00	3.94 - 14.17	16.54	24.80	2.95	17.99	2.20	.79	9.84	7.40	11.54



* Design Factor based on EN 13155, and ASME B30.20.

www.transportutstyr.no

Tlf./Phone +47 63 87 10 80



FOR CONTROLLED TILTING AND TRANSPORT

The IPSTARTEC11 beam clamp has been specially developed for lifting with the body in vertical position, controlled tilting, transportation and stacking of steel "H" and "I" profiles. By placing the chain guide in the appropriate position, it is easy to switch from lifting to tilting and back again, which shifts the center of gravity.

For correct use of the clamp, please consult fig. 2 & 3.



IPSTARTEC11

Spare parts for IPSTARTEC11 lifting clamps: Order no.

1. body complete	1041
3. camsegment complete	1234
4. latch complete	1233
5. spring for latch complete	1063
6. camsegment shaft complete	1046
7. hoisting eye shaft complete	1047
10. pivot complete	0098
13. latch plate shaft complete	1339
19. chain complete	1239
20. guiding arm	1352
59. handle complete	0341

fig. 1

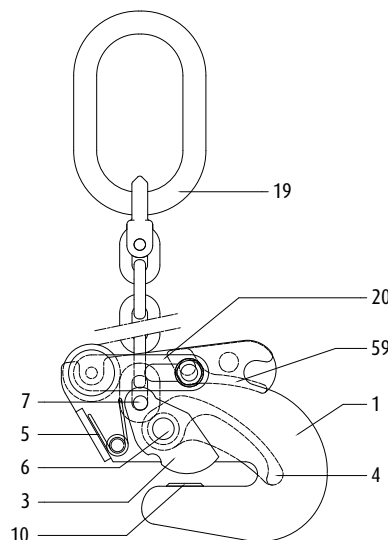
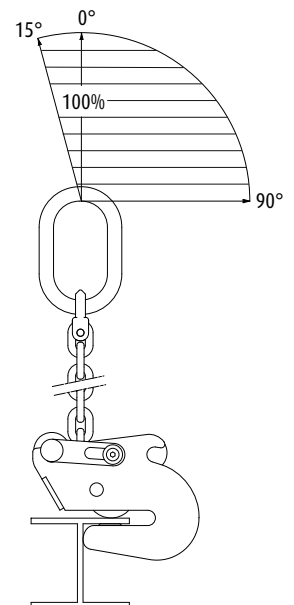

fig. 2



Dimensions in mm

Model	Stock No.	WLL Each (t.)	Weight Each (kg.)	Jaw A	B	C	D	E	F	G	H	J	K
1,5 IPSTARTEC11	1812	1,5	6,6	6-12	140	39	575	110	81	129	54	126	16
2,5 IPSTARTEC11	1822	2,5	14,5	6-20	210	55	725	135	115	182	74	140	18

* Design Factor based on EN 13155, and ASME B30.20.

www.transportutstyr.no

Tlf./Phone +47 63 87 10 80



- Available in capacities of 1.5 and 2.5 metric tons.
- Jaw openings available: 6 to 20mm | .25" - .75".
- Welded alloy steel body for strength and smaller size. Forged alloy components, where required.
- Individually Proof Tested to 2 times the Working Load Limit with certification.
- Company name (CrosbyIP), logo, Working Load Limit and jaw opening permanently stamped on body.
- Each product is individually serialized, with the serial number and Proof Load test date stamped on body. Serial number is included on the test certificate with maintenance and warranty logbook.
- Maintenance replacement parts are available.
- Manufactured by a ISO 9001 facility.
- All sizes are RFID EQUIPPED.



Transport

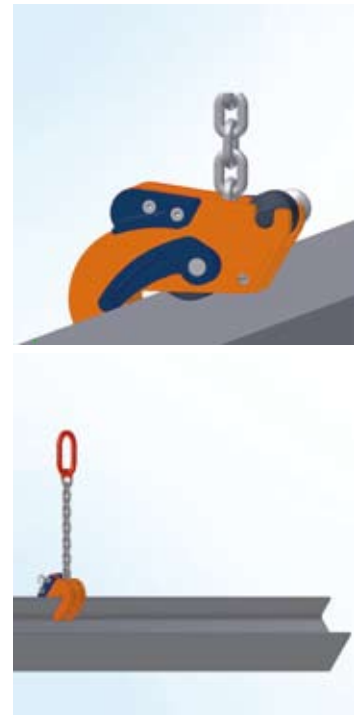

Controlled tilting

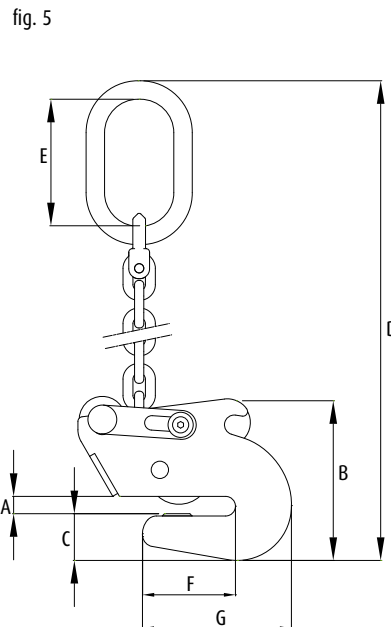
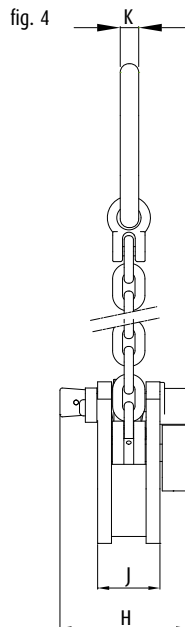
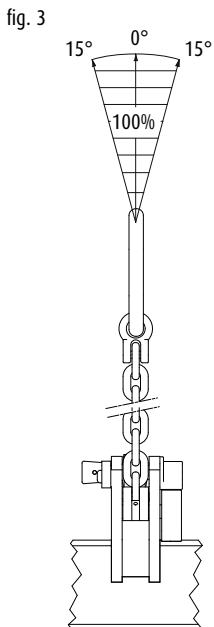
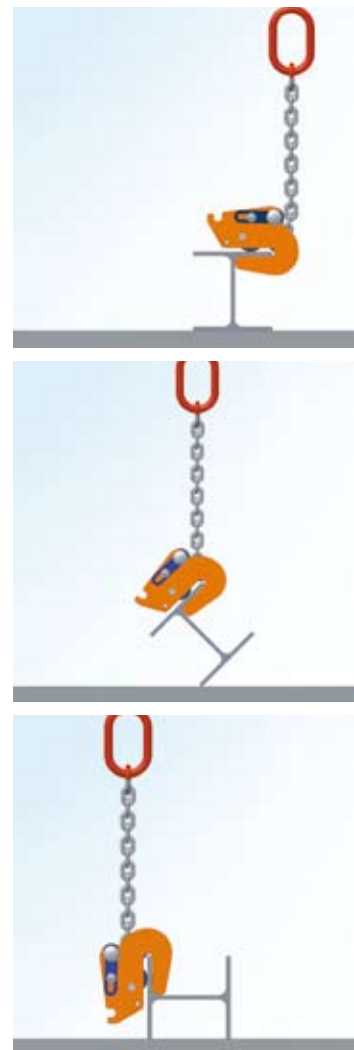

Dimensions in inches

Model	Stock No.	WLL Each (t.)	Weight Each (lbs.)	Jaw A	B	C	D	E	F	G	H	J	K
1.5 IPSTARTEC11	2701812	1.5	14.6	.25 - .50	5.51	1.54	22.64	4.33	3.19	5.08	2.13	4.96	.63
2.5 IPSTARTEC11	2701822	2.5	32.0	.25 - .75	8.27	2.17	28.54	5.31	4.53	7.17	2.91	5.51	.71

* Design Factor based on EN 13155, and ASME B30.20.